

Diesel Pile Hammer **DELMAG**

D21-42 to D46-32

Technical data		D21-42	D25-32	D30-32	D36-32	D46-32
Impact weight (piston)	kg	2100	2500	3000	3600	4600
Energy per blow	kNm	75-40	90-40	103-48	123-56	166-71
Number of blows	min ⁻¹	35-50	35-52	36-52	36-53	35-53
Suitable for driving piles (depending on soil and pile)	kg	1100-7500	1600-7500	2000-9000	2500-12000	3000-16000
Consumption						
Diesel oil	l/h	7,5	7,5	10	11,5	16
Lubricant	l/h	1	0,6	1	1,5	1,5
Tank capacity						
Diesel oil tank	l	60	67	67	89	89
Lube tank	l	10	19	19	17	17
Max. rope diameter for deflector sheave of tripping device	mm	22	22	22	38	38
Weight						
Tripping device	kg	180	180	180	400	400
Diesel pile hammer	kg	4600	5530	6030	7990	8990
Max. inclined pile driving without / with extension		1:5 / 1:1	1:5 / 1:1	1:5 / 1:1	1:5 / 1:1	1:5 / 1:1

Dimensions

A	Length of Diesel pile hammer without extension	mm	5370	5450	5450	5470	5470
B	Outer diameter of impact block	mm	500	560	560	660	660
C	Width of Diesel pile hammer	mm	580	640	640	785	785
D	Width for connection of guide jaws	mm	540	540	540	640	640
E	Center of hammer to pump guard	mm	406	405	405	445	445
F	Center of hammer to center of threads for guide jaw bolts	mm	235	235	235	275	275
G	Depth of Diesel pile hammer	mm	760	715	715	848	848
H	Standard distance from center of Diesel pile hammer up to the face of lead	mm	415	435	435	500	500

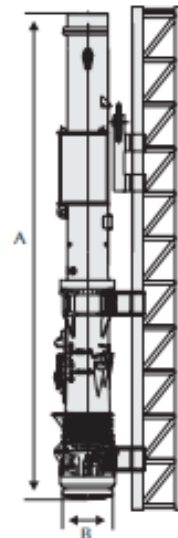
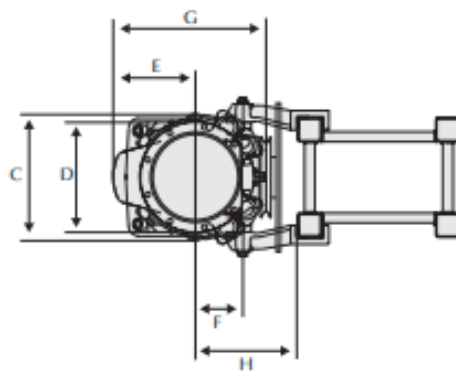

© DELMAG April 2006. Subject to changes.